



TEK 2.0

QUICK START GUIDE

Thank you for choosing SportDOG Brand® tracking and training products. This is an abbreviated guide designed to familiarize you with the product. To ensure your satisfaction, please thoroughly review the full Operating Guide available online at www.sportdog.com/support/tek2.0.

To get the most protection out of your Two Year Warranty, please register your product within 30 days at www.sportdog.com. By registering and keeping your receipt you will enjoy the product's full warranty and, should you ever need to call the Customer Care Center, we will be able to help you faster. Most importantly, your valuable information will never be given or sold to anyone. Complete warranty information is available online at www.sportdog.com.

TABLE OF CONTENTS

HOW IT WORKS	3
CHARGING THE BATTERIES.....	3
TURNING ON/OFF	4
TEK 2.0 SETUP	4
CALIBRATE THE COMPASS.....	4
FIT THE GPS COLLAR WITH E-COLLAR MODULE	5
CONNECTING TO A COMPUTER	5
WARRANTY	6
TERMS OF USE AND LIMITATION OF LIABILITY.....	7
COMPLIANCE	9
CUSTOMER CARE CENTER / SERVICE CLIENTÈLE	10
BATTERY DISPOSAL	10
IMPORTANT RECYCLING ADVICE	10



SEE IMPORTANT SAFETY INFORMATION IN YOUR OPERATING GUIDE! READ AND UNDERSTAND ALL SAFETY INFORMATION BEFORE USING THIS PRODUCT.

TEK SERIES TEK-V2LT SYSTEM CONTAINS:

- Handheld Device with Antenna • GPS Collar with E-Collar Module on Red Collar Strap
- Location-only Module • Gear Bag • Charge Cradle • Adapter • USB Cables
- Basic Training DVD and Manual • Quick Start Guide • Long Contact Points • Test Light
- Lanyard • Allen Wrench

TEK SERIES TEK-V2L SYSTEM CONTAINS:

- Handheld Device with Antenna • GPS Collar on Red Collar Strap • Gear Bag • Charge Cradle
- Adapter • USB Cables • Basic Training DVD and Manual • Quick Start Guide • Lanyard

HOW IT WORKS

The SportDOG Brand® TEK Series 2.0 Systems have been proven safe, comfortable, and effective for all dogs over 8 pounds (3.6 kg). Consistent, correct use of this product allows you to track your dog, reinforce commands, and correct misbehavior from up to 10 miles line of sight.

The Handheld Device receives your location from its built-in GPS antenna and receives location updates from the GPS antenna mounted on the Collar to track the location of your dog. The Handheld Device sends a signal, activating the E-Collar Module to deliver a harmless stimulation.* With proper training, a dog will learn to associate the signal with a command. Like all SportDOG™ products, this model features adjustable stimulation levels so you can tailor the stimulation level to your dog's temperament, eliminating the risk of over-correction.

TEK-V2LT and TEK-2AD have E-Collar functionality. To add E-Collar functionality to your TEK-V2L, you must purchase the TEK-2T E-Collar Module.

IMPORTANT: The TEK Series 2.0 System has a range of up to 10 miles line of sight. Depending on the way you hold the Handheld Device, the maximum range may vary. For consistent results at longer ranges, hold the Handheld Device in a vertical position away from your body and above your head. Terrain, weather, vegetation, transmissions from other radio devices, and other factors will affect the maximum range.

STEP :: 01

CHARGING THE BATTERIES

TO CHARGE THE HANDHELD DEVICE:

1. Lift the rubber cover protecting the charging jack.
2. Connect the appropriate charger connector to the charging jack.
3. Plug the charger into a standard 120/240-volt AC wall outlet.
4. Charge the Handheld Device for up to 8 hours for the first charge and every charge thereafter. It is not harmful to let the unit charge more than 8 hours. Charge times may be longer using a non-specified charger.
5. When charging is complete, as indicated by a full bar on the battery icon, replace the rubber cover.

NOTE: Approximate battery life between charges is 12 hours, depending on the frequency of use.

TO CHARGE THE GPS COLLAR/E-COLLAR MODULE:

1. Attach the supplied Charge Cradle so that the SportDOG Brand® logo on the Charge Cradle covers the SportDOG Brand logo on the GPS Collar.
2. Connect the appropriate charger connector to the charging jack.
3. Plug the charger into a standard 120/240-volt AC wall outlet.
4. Charge the GPS Collar for 4 hours for the first charge and every charge thereafter. It is not harmful to let the unit charge more than 4 hours.
5. When charging is complete, as indicated by the Indicator Light blinking green, remove the Charge Cradle.

NOTE: Approximate battery life between charges is 24 hours (at the 3 second update rate) depending on the frequency of use.

STEP :: 02

TURNING ON/OFF

TO TURN THE HANDHELD DEVICE ON:

Firmly press and release the On/Off button. The unit will vibrate and the start-up screen will display.

TO TURN THE HANDHELD DEVICE OFF:

Firmly press and hold the On/Off button. Release when the display goes blank.

TO TURN THE GPS COLLAR/E-COLLAR MODULE ON:

Press the On/Off button and release when the GPS Indicator Light comes on green. The GPS Collar will beep 1 to 5 times indicating which channel the collar is on.

TO TURN THE GPS COLLAR/E-COLLAR MODULE OFF:

Press and hold the On/Off button until the GPS Indicator Light comes on solid red and the GPS Collar beeps for 2 seconds. To extend the battery life between charging cycles, turn off the GPS Collar when it is not in use.

STEP :: 03

TEK 2.0 SETUP

The first time you turn on your TEK 2.0 Handheld Device, the Setup Wizard will walk you through setting up your device. If you choose to skip the customization process by selecting DEFAULT SETTINGS when the Setup Wizard asks "Would you like to follow the guided setup or use the default settings?", your Handheld Device will, by default, have one dog and one collar paired so that you can go directly to the field. Should you need to add additional dogs, collars, or hunters or pair your collar again, please follow the steps in the online Operating Guide.

STEP :: 04

CALIBRATE THE COMPASS

From the Home Screen, select Compass. Press the Menu Button and select Calibrate. You will need to rotate the Handheld Device in all three dimensions as indicated below until the message on the display goes away.

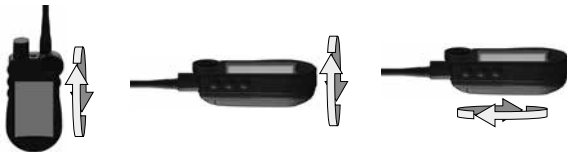

Your setup is now complete. Use the Settings page to adjust settings at any time.

STEP :: 05

FIT THE GPS COLLAR WITH E-COLLAR MODULE

Put the collar around your dog's neck and adjust to find the proper fit, making sure the GPS antenna is at the back of your dog's neck for best reception. Fasten the collar so the fit is snug yet loose enough to allow one finger to fit between the strap and the dog's neck. Fit is important because a loose collar may cause inconsistent performance.

STEP :: 06

CONNECTING TO A COMPUTER

1. Go to www.sportdog.com/support/tek2.0.
 2. Download and install the SportDOG™ Companion Application software.
 3. To ensure you have the latest features, update the Handheld Device's firmware and map data.
- For a full version of the Operating Guide go to www.sportdog.com/support/tek2.0.

WARRANTY

TWO YEAR NON-TRANSFERRABLE LIMITED WARRANTY

This Product has the benefit of a limited manufacturer's warranty. Complete details of the warranty applicable to this Product and its terms can be found at www.sportdog.com and/or are available by contacting your local Customer Care Center.

- Radio Systems Corporation, 10427 PetSafe Way, Knoxville, TN 37932 USA

Australia/New Zealand – In compliance with the Australian Consumer Law, Warranties Against Defects, effective January 1, 2012, warranty details of this Product are as follows:

Two Year Non-Transferrable Limited Warranty

What is covered: Radio Systems Australia Pty Ltd. (hereinafter referred to as "Radio Systems") warrants to the original retail purchaser, and not any other purchaser or subsequent owner, that its Product, when subject to normal and proper residential use, will be free from defects in material or workmanship for a period of two (2) years from the purchase date. An "original retail consumer purchaser" is a person or entity who originally purchases the Product, or a gift recipient of a new Product that is unopened and in its original packaging. When serviced by Radio Systems Customer Service, Radio Systems covers labour and parts for the first two years of ownership; after the first two years, a service or upgrade charge will apply relative to replacement of the Product with new or refurbished items at Radio System's sole discretion.

The limited warranty is non-transferrable and shall automatically terminate if the original retail consumer purchaser resells the Radio Systems Product or transfers the property on which the Radio Systems Product is installed. This Limited Warranty excludes accidental damage due to dog chews; lightning damage; or neglect, alteration, and misuse. Consumers who purchase Products outside of Australia, New Zealand, or from an unauthorised dealer will need to return the Product to the original place of purchase for any warranty issues.

Please note that Radio Systems does not provide refunds, replacements, or upgrades for change of mind, or for any other reason outside of these Warranty terms.

Claims Procedure

Any claim made under this Warranty should be made directly to Radio Systems Australia Pty Ltd. Customer Care Centre at:

Radio Systems Australia Pty Ltd.
PO Box 765, Mudgeeraba QLD 4213
Australia Residents: 1800 786 608
New Zealand Residents: 0800 543 054
Email: info@petsafeaustralia.com.au

To file a claim, a proof of purchase must be provided. Without a proof of purchase, Radio Systems will not repair or replace faulty components. Radio Systems requests the Consumer to contact the Radio Systems Customer Care Centre to obtain a Warranty Return number, prior to sending the Product. Failure to do so may delay in the repair or replacement of the Product.

If the Product is deemed to be faulty within 30 days from date of original purchase, Radio Systems will organise for a replacement to be sent in advance of returning the faulty Product. A Post Bag will be included with the replacement Product for the return of the faulty Product. The Product must be returned within 7 days of receiving the replacement. If the Product is deemed to be faulty after 30 days from the date of original purchase, the consumer will be required to return the Product to Radio Systems at the consumer's own expense. Radio Systems will test and replace the faulty unit or its components and return to the consumer free of charge, provided the Product is within its said warranty period. This warranty is in addition to other rights and remedies available to you under the law. Radio Systems goods come with guarantees that cannot be excluded under the Australian Consumer Law. You are entitled to a replacement or refund for a major failure and for compensation for any other reasonably foreseeable loss or damage. You are also entitled to have the goods repaired or replaced if the goods fail to be of acceptable quality and the failure does not amount to a major failure.

Should you have any queries or require any further information, please contact our Customer Care Centre on 1800 786 608 (Australia) or 0800 543 054 (New Zealand).

TERMS OF USE AND LIMITATION OF LIABILITY

FOR PRODUCTS PURCHASED WITHIN THE UNITED STATES:

1. TERMS OF USE

This Product is offered to you conditioned upon your acceptance without modification of the terms, conditions, and notices contained herein. Usage of this Product implies acceptance of all such terms, conditions, and notices.

2. PROPER USE

This Product is designed for use with dogs where tracking and training are desired. The specific temperament of your dog may not work with this Product. We recommend that you not use this Product if your dog is less than 8 pounds or if your dog is aggressive. If you are unsure whether this is appropriate for your dog, please consult your veterinarian, certified trainer, or contact our Customer Care Center at 1-800-732-0144. Proper use includes reviewing the entire Operating and Training Guide, and any specific safety information.

3. NO UNLAWFUL OR PROHIBITED USE

This Product is designed for use with dogs only. This dog tracking and training device is not intended to harm, injure, or provoke. Using this Product in a way that is not intended could result in violation of Federal, State, or local laws.

4. LIMITATION OF LIABILITY

In no event shall Radio Systems Corporation be liable for any direct, indirect, punitive, incidental, special or consequential damages, or any damages whatsoever arising out of or connected with the use or misuse of this Product. Buyer assumes all risks and liability from the use of this Product.

5. MODIFICATION OF TERMS AND CONDITIONS

Radio Systems Corporation reserves the right to change the terms, conditions, and notices under which this Product is offered.

TERMS OF USE AND LIMITATION OF LIABILITY

FOR PRODUCTS PURCHASED OUTSIDE OF THE UNITED STATES:

1. TERMS OF USE

Use of this Product is subject to your acceptance without modification of the terms, conditions, and notices contained herein. Use of this Product implies acceptance of all such terms, conditions, and notices. If you do not wish to accept these terms, conditions, and notices, please return the Product, unused, in its original packaging and at your own cost and risk to the relevant Customer Care Centre together with proof of purchase for a full refund.

2. PROPER USE

This Product is designed for use with dogs where tracking and training are desired. The specific temperament or size/weight of your dog may not be suitable for this Product. Radio Systems Corporation recommends that this Product is not used if your dog is aggressive and accepts no liability for determining suitability in individual cases. If you are unsure whether this Product is appropriate for your dog, please consult your veterinarian or certified trainer prior to use. Proper use includes, without limitation, reviewing the entire Operating Guide and any specific safety information.

3. NO UNLAWFUL OR PROHIBITED USE

This Product is designed for use with dogs only. This dog tracking and training device is not intended to harm, injure, or provoke. Using this Product in a way that is not intended could result in violation of Federal, State, or local laws.

4. LIMITATION OF LIABILITY

In no event shall Radio Systems Corporation or any of its associated companies be liable for (i) any indirect, punitive, incidental, special or consequential damage and/or (ii) any loss or damages whatsoever arising out of or connected with the misuse of this Product. The Purchaser assumes all risks and liability from the use of this Product to the fullest extent permissible by law.

5. MODIFICATION OF TERMS AND CONDITIONS

Radio Systems Corporation reserves the right to change the terms, conditions, and notices governing this Product from time to time. If such changes have been notified to you prior to your use of this Product, they shall be binding on you as if incorporated herein.

COMPLIANCE

FCC

This device complies with part 15 of the FCC Rules. Operation is subject to the following two conditions: (1) This device may not cause harmful interference, and (2) this device must accept any interference received, including interference that may cause undesired operation.

This equipment has been tested and found to comply with the limits for a Class B digital device, pursuant to part 15 of the FCC Rules. These limits are designed to provide reasonable protection against harmful interference in a residential installation. This equipment generates, uses, and can radiate radio frequency energy and, if not installed and used in accordance with the instructions, may cause harmful interference to radio communications. However, there is no guarantee that interference will not occur in a specific installation. If interference does occur to radio or television reception, which can be determined by turning the equipment off and on, the user is encouraged to try to correct the interference by one or more of the following measures:

- Reorient or relocate the receiving antenna.
- Increase the separation between the equipment and the receiver.
- Connect the equipment to an outlet on a circuit different from that to which the receiver is connected.
- Contact customer service or an experienced radio/TV technician for assistance.

CAUTION

Unauthorized changes or modifications to the equipment may violate FCC regulations and could void the user's authority to operate the equipment.

IC - CANADA

This device complies with Industry Canada licence-exempt RSS standard(s). Operation is subject to the following two conditions: (1) this device may not cause interference, and (2) this device must accept any interference, including interference that may cause undesired operation of the device.

This device has been designed to operate with the antennas provided with the equipment. Use of other antennas may violate Industry Canada rules and void the user's authority to operate the equipment.

Le présent appareil est conforme aux CNR d'Industrie Canada applicables aux appareils radio exempts de licence. L'exploitation est autorisée aux deux conditions suivantes : (1) l'appareil ne doit pas produire de brouillage, et (2) l'utilisateur de l'appareil doit accepter tout brouillage radioélectrique subi, même si le brouillage est susceptible d'en compromettre le fonctionnement.

Ce dispositif a été conçu pour fonctionner avec les antennes fournies avec ce produit. L'utilisation d'autres antennes peut enfreindre les règles industrielles du Canada et annuler l'autorité de l'utilisateur quant au fonctionnement de l'équipement.

AUSTRALIA



This device complies with the applicable EMC requirements specified by the ACMA (Australian Communications and Media Authority).

CUSTOMER CARE CENTER / SERVICE CLIENTÈLE

UNITED STATES AND CANADA

Tel: 800-732-0144

Monday - Friday / Lundi - Vendredi
8 AM - 8 PM EST / 8h00 - 20h00 EST

Saturday / Samedi

9 AM - 5 PM EST / 9h00 - 17h00 EST

AUSTRALIA

Tel: 1800 786 608

Monday - Friday 8:30 AM - 5 PM

NEW ZEALAND

Tel: 0800 543 054

Monday - Friday 10:30 AM - 7 PM



BATTERY DISPOSAL

WARNING

Please see the TEK Series 2.0 Operating Guide for Important Safety Information related to the batteries.

Separate collection of spent batteries is required in many regions; check the regulations in your area before discarding spent batteries.

This system operates on two Li-Ion battery packs (2000mAh capacity for the GPS Collar and 4400mAh capacity for the Handheld Device). Call the Customer Care Center if your battery needs to be replaced. For a listing of Customer Care Center telephone numbers, visit our website at www.sportdog.com.



IMPORTANT RECYCLING ADVICE

Please respect the Waste Electrical and Electronic Equipment regulations in your country. This equipment must be recycled. If you no longer require this equipment, do not place it in the normal municipal waste system. Please return it to where it was purchased in order that it can be placed in our recycling system. If this is not possible, please contact the Customer Care Center for further information. For a listing of Customer Care Center telephone numbers, visit our website at www.sportdog.com.

This product is protected by the following patents:

U.S. Patent Numbers: 7,343,879; 7,174,855; 6,184,790; 6,459,378 and other patents pending.



**GEAR THE WAY
YOU'D DESIGN IT®**



**GEAR THE WAY
YOU'D DESIGN IT®**

SPORTDOG.COM